

SurgeSim

Visual

Geyserville Hospital

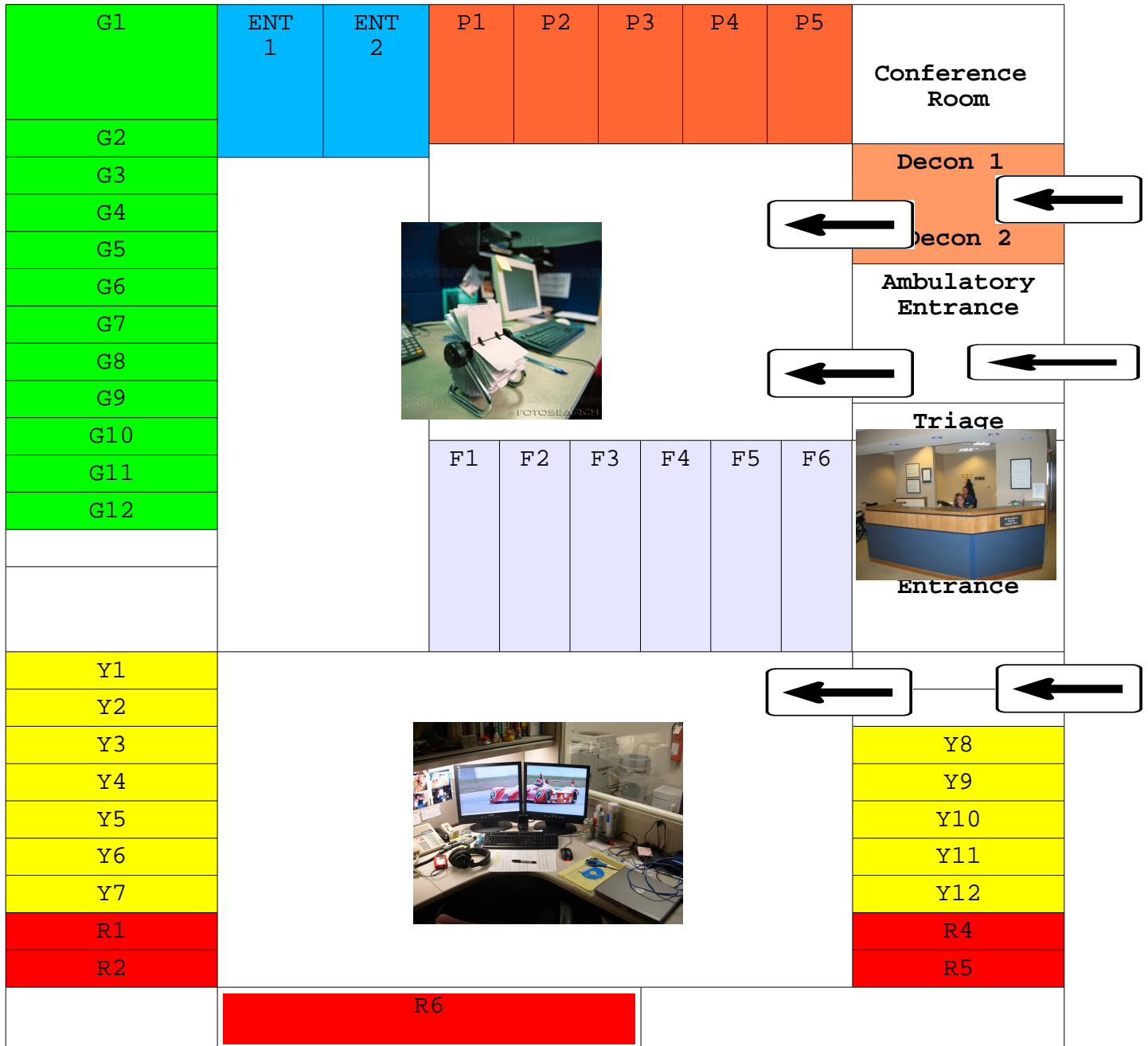



Characteristics of the Geyserville Hospital

STAFFING

- Physician staffing is based on eight hour shifts. A designated Pediatric physician is present from 0800-0000.
 - 0800-1600: 3 Physicians (red/yellow; green/FT; Peds)
 - 1600-0000: 3 Physicians (red/yellow; green/FT; Peds)
 - 0000-0800: 3 Physicians (red/yellow; green/FT/Peds)

POD DESCRIPTION

1. RED Pod
 - a) Six Beds
 - b) All beds have 1:1 Nursing
 - c) All beds have monitor, defibrillator, airway equipment
 - d) R6 has overhead X-ray
2. YELLOW Pod
 - a) Twelve Beds
 - b) Usually 3:1 Patient:Nurse ratio
 - c) All beds have monitors, oxygen
 - d) Can take intubated patients if necessary
3. GREEN Pod
 - a) Twelve Beds
 - b) Beds do not have monitors
 - c) Usually 4:1 Patient:Nurse ratio
4. PEDS Pod
 - a) Five beds
 - b) Can accommodate adult or pediatric patients
 - c) Usually 3 nurses for 5 beds
5. Fast Track
 - a) Six Chairs. Two ENT Chairs.
 - b) Rooms are too small to accommodate beds
6. Decontamination
 - a) Two decontamination beds.
 - b) All Decontamination equipment present.
 - c) Separate entrance to ambulance bay.
 - d) No nurses assigned; will need to be reassigned from other areas.
 - e) Can accommodate intubated patients.